

MAP AND DIRECTIONS TO THE SPRAGUE BUILDING FROM MEDICAL SCHOOL CAMPUS

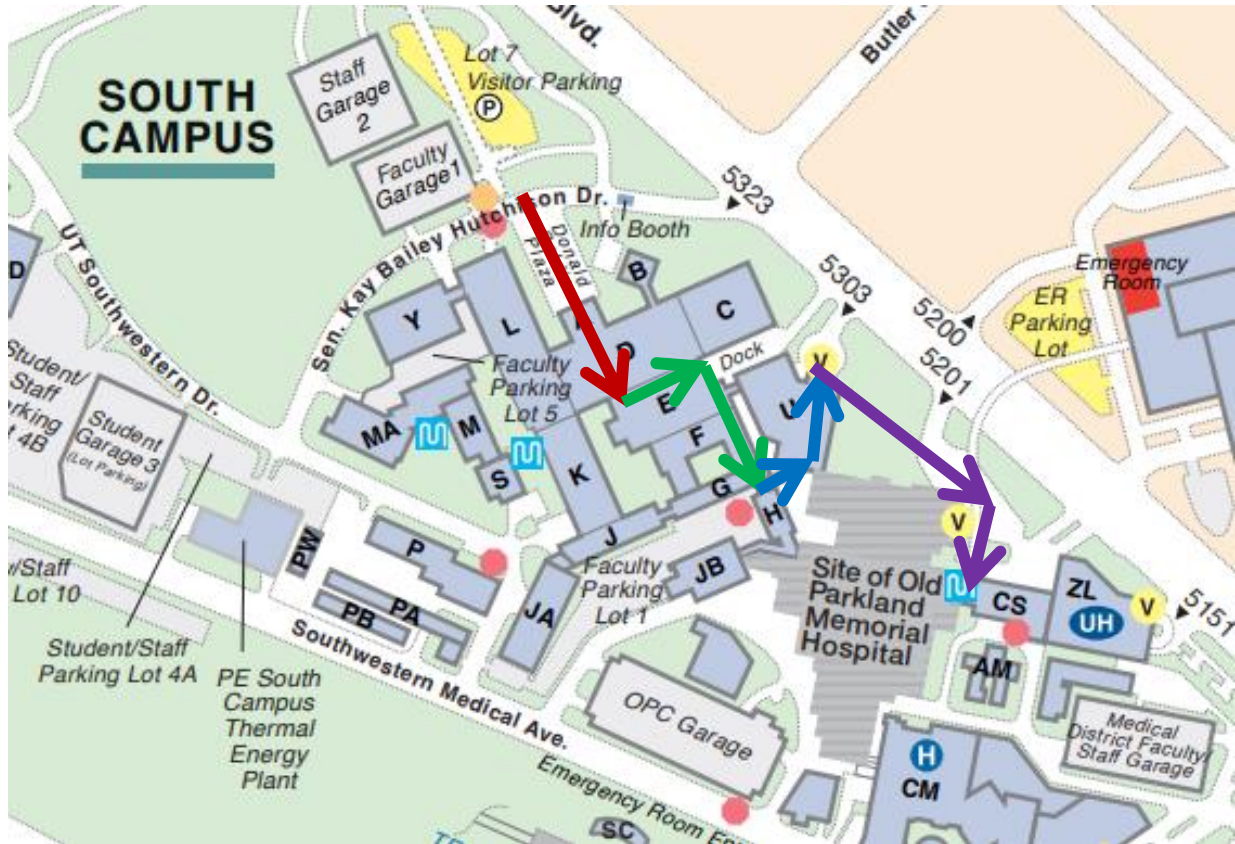

Red Arrow: Starting from the Donald Seldin Plaza, cross through the breezeway onto the area with the flagpoles. You will be walking over the D building which is technically underground.

Green Arrows: Once you enter the E building (in front of the library), take a LEFT and then a RIGHT and follow the long hallway through buildings E, F, and G. You will enter a small room with a glass door on your left leading outside to another building and sliding glass double doors on your right leading to a parking lot.

Blue Arrows: Go through the door on your LEFT and head to the ASTON building (Building U). You will briefly go outside and then enter the Aston building by a set of elevators. Continue straight through the building, and it will open into the Aston building lobby.

Purple Arrows: Exit the front entrance of Aston and make a RIGHT. You will be on the lawn in front of the Old Parkland Memorial Hospital. Walk in front of Old PMH until you see the breezeway between Old PMH and Zale Lipshy Hospital. You will enter the building from the breezeway on the far side, and you will be in the Sprague Building (CS on the map). There is a bank of elevators as you enter the building. Take those elevators to the 2nd floor.

- The CHAIRMAN'S CONFERENCE ROOM (CS2.120) is across the hall to your left.
- For the GIESECKE CONFERENCE ROOM (CS.238), take a right when exiting the elevators and enter the Anesthesia offices (Suite CS2.126) at the end of the hallway on the right. When you are in the Anesthesia offices, take your first hallway to the right, and the Giesecke Conference Room will be the 3rd door on your left.
- Dr. Woods's Office (CS2.540) is directly across the hall from the Giesecke Conference Room.